

3 Drawer Dresser

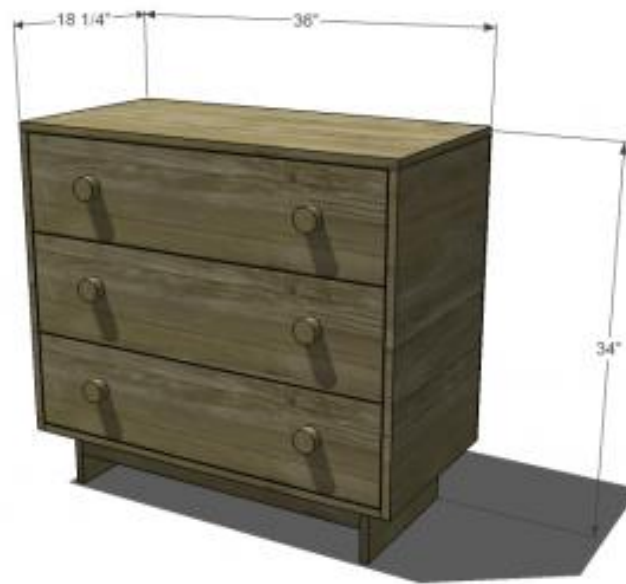

Materials:

- (1) Sheet of $\frac{3}{4}$ " plywood
- (1) 1x3 at 6' long
- (1) 1x6 at 3' long
- (2) 1x8 at 8' long
- (1) Sheet of $\frac{1}{4}$ " plywood
- (3) Sets of 16" drawer sliders
- (3) Drawer pulls
- 1 $\frac{1}{4}$ " Pocket hole screws
- 1 $\frac{1}{4}$ " brad nails

Cut List:

- 2 – 1×6 at 14” –Base
- 1 – $\frac{3}{4}$ ” plywood at 18” x 34- $\frac{1}{2}$ ” – Bottom
- 2 – 1×3 at 29” – Base Stretchers
- 2 – $\frac{3}{4}$ ” plywood at 18” x 27- $\frac{3}{4}$ ” – Sides
- 2 – $\frac{3}{4}$ ” plywood at 17- $\frac{1}{4}$ ” x 34- $\frac{1}{2}$ ” – Shelves
- 1 – $\frac{1}{4}$ ” plywood at 27- $\frac{3}{4}$ ” x 36” – Back
- 1 – $\frac{3}{4}$ ” plywood at 18- $\frac{1}{4}$ ” x 36” – Top
- 6 – 1×8 at 14- $\frac{1}{2}$ ” – Drawer Box
- 6 -1×8 at 33- $\frac{1}{2}$ ” – Drawer Box
- 3 – $\frac{1}{4}$ ” plywood at 16” x 33- $\frac{1}{2}$ ” – Drawer Bottom
- 2 – $\frac{3}{4}$ ” plywood at 8- $\frac{3}{4}$ ” x 34- $\frac{1}{4}$ ” – Drawer Fronts
- 1 – $\frac{3}{4}$ ” plywood at 9” x 34- $\frac{1}{4}$ ” – Middle Drawer Front

Step 1:

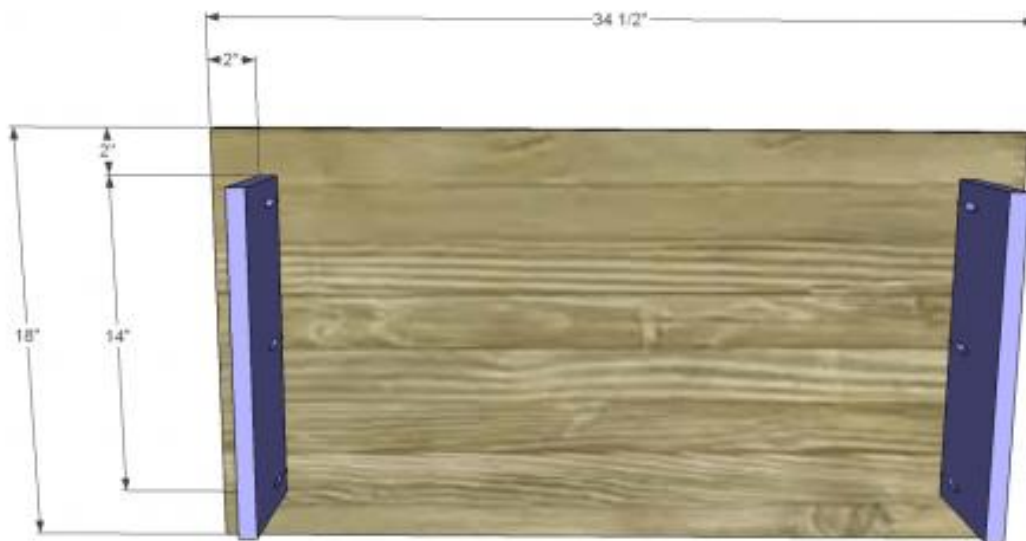

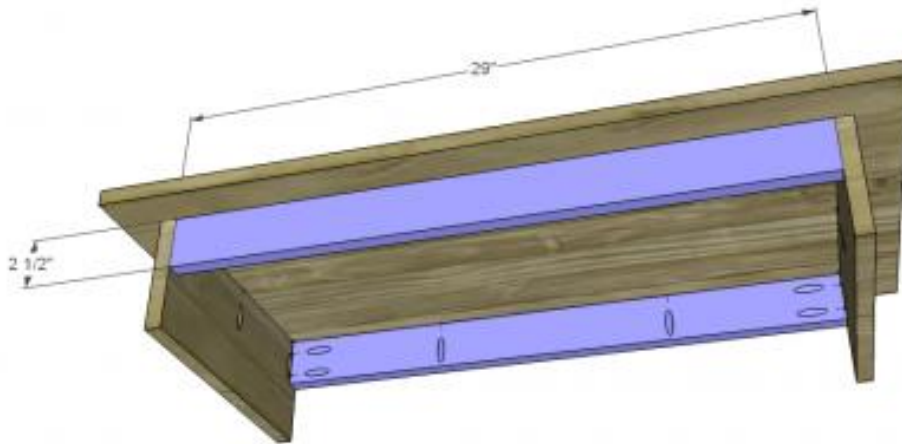

Apply optional edge banding to exposed edges of plywood before assembly. Cut the pieces for the base and bottom. Set the Kreg jig for $\frac{3}{4}$ " material and drill pocket holes in one long edge of each base piece. Also drill pocket holes in each end of the bottom to attach the sides. Position the base pieces on the bottom as shown and attach using glue and 1-1/4" pocket hole screws. Cut the pieces for the base stretchers. Drill pocket holes in each end as well as one long edge of each piece. Attach to the bottom and existing base pieces using glue and 1-1/4" pocket hole screws.

Step 2:

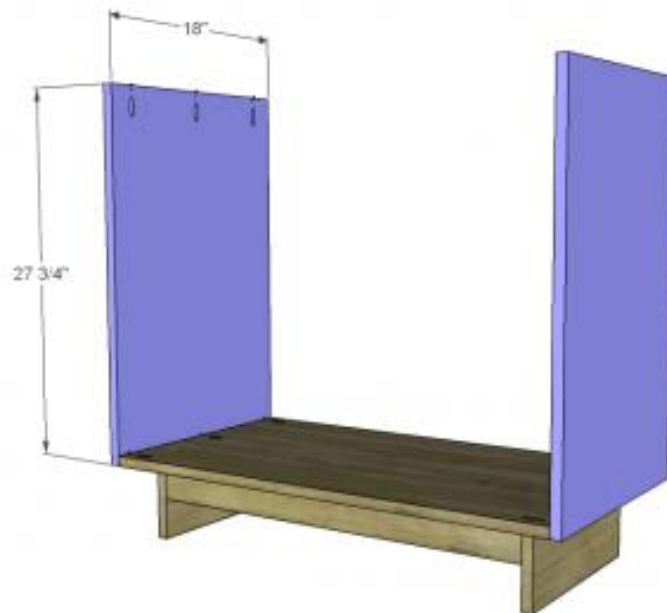

Cut the pieces for the sides. Drill pocket holes in the top edge of each piece to attach the top. Attach to the bottom using glue and 1-1/4" pocket hole screws.

Step 3:

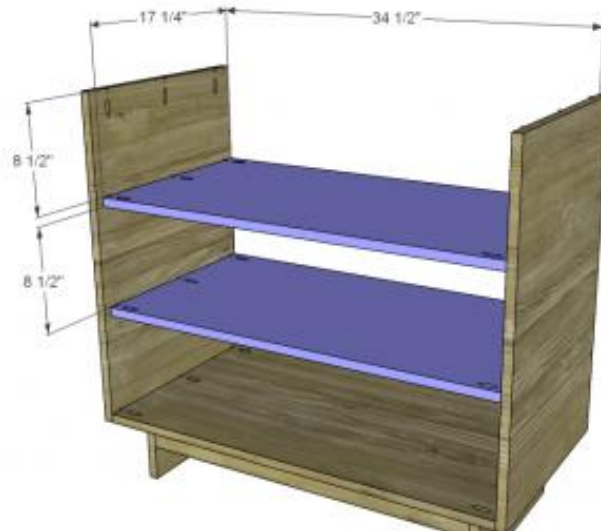

Cut the piece for the shelves. Drill pocket holes in each edge. Secure to the sides as shown using glue and 1-1/4" pocket hole screws. The shelves will be set 3/4" back from the front edge of the sides.

Step 4:

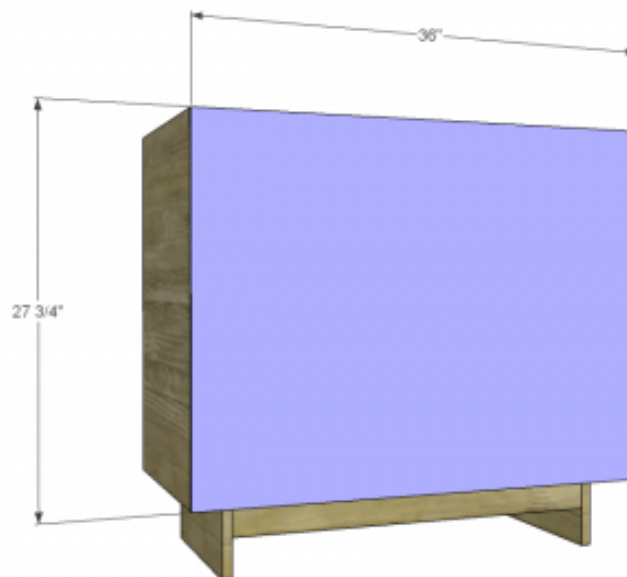

Cut the piece for the back and attach using glue and 1-1/4" brad nails.

Step 5:



Cut the piece for the top. Attach to the sides using glue and 1-1/4" pocket hole screws.

Step 6:



Cut the pieces for the drawer boxes. Assemble as shown using glue and 1-1/4" pocket hole screws. Cut the pieces for the drawer bottoms. Attach to the drawer boxes using glue and 1-1/4" brad nails. Attach the drawer slide hardware according to the manufacturer's instructions. Make any necessary adjustments.

Step 7:

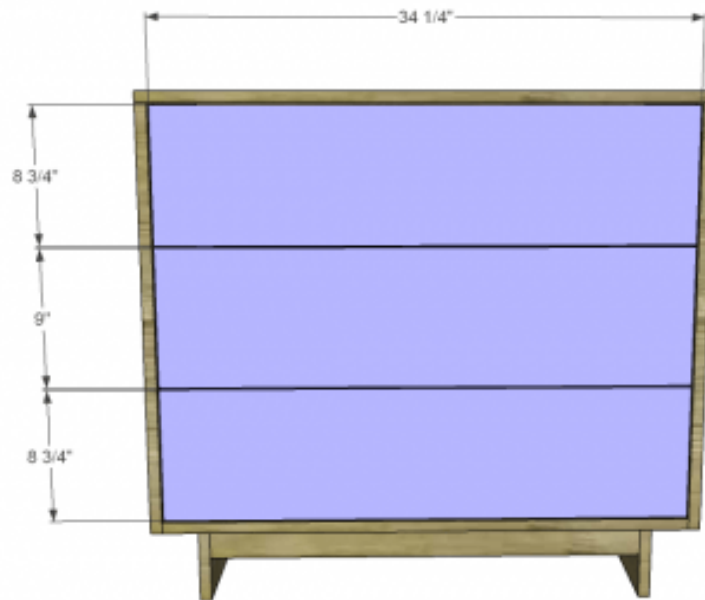

Cut the pieces for the drawer fronts. There will be a 1/8" gap all around. Attach the drawer pulls.

Fill any Screw, Nail or Pocket Holes, Sand and Finish as Desired.