

3 Drawer Dresser

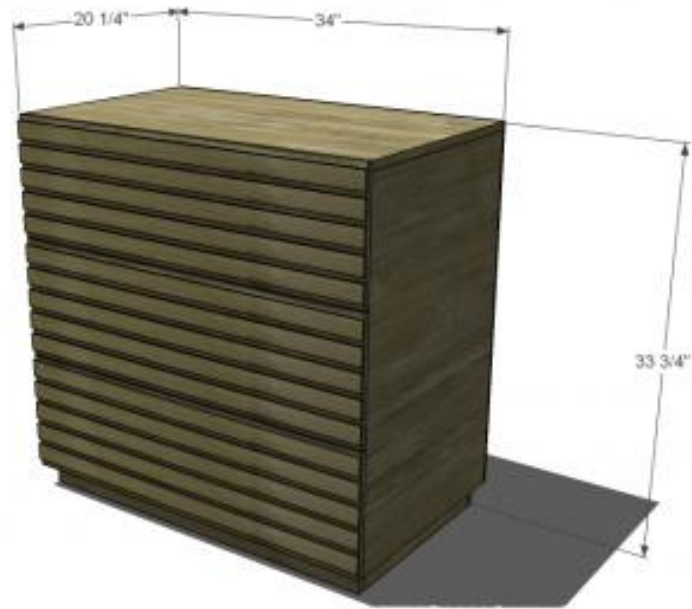

Materials:

- 4' x 8' x 3/4" plywood
- 4' x 8' x 1/4" plywood
- 4' x 4' x 1/2" plywood
- (1) 1x3 @ 6' long
- (1) 1x3 @ 4' long
- (4) 1x8 @ 8' long
- (1) 1x8 @ 4' long
- 1 1/2" pocket hole screws
- 1" brads
- (3) sets of 18" drawer slides

Cut List:

- 2 – $\frac{3}{4}$ " plywood at 19- $\frac{3}{4}$ " x 31" – Sides
- 1 – $\frac{3}{4}$ " plywood at 19- $\frac{3}{4}$ " x 32- $\frac{1}{2}$ " – Bottom
- 1 – $\frac{3}{4}$ " plywood at 20- $\frac{1}{4}$ " x 34" – Top
- 1 – $\frac{1}{4}$ " plywood at 31- $\frac{3}{4}$ " x 34" – Back
- 2 – 1x3 (ripped to 2" wide) x 16- $\frac{3}{4}$ " – Pedestal
- 2 – 1x3 (ripped to 2" wide) x 32- $\frac{1}{2}$ " – Pedestal
- 6 – 1x8 at 16- $\frac{1}{2}$ " – Drawer Boxes
- 6 – 1x8 at 31- $\frac{1}{2}$ " – Drawer Boxes
- 3 – $\frac{1}{4}$ " plywood at 18" x 31- $\frac{1}{2}$ " – Drawer Bottoms
- 3 – $\frac{1}{2}$ " plywood at 10- $\frac{1}{2}$ " x 34" – Drawer Fronts
- 15 – $\frac{1}{4}$ " plywood at 1- $\frac{1}{2}$ " x 34" – Trim Slats

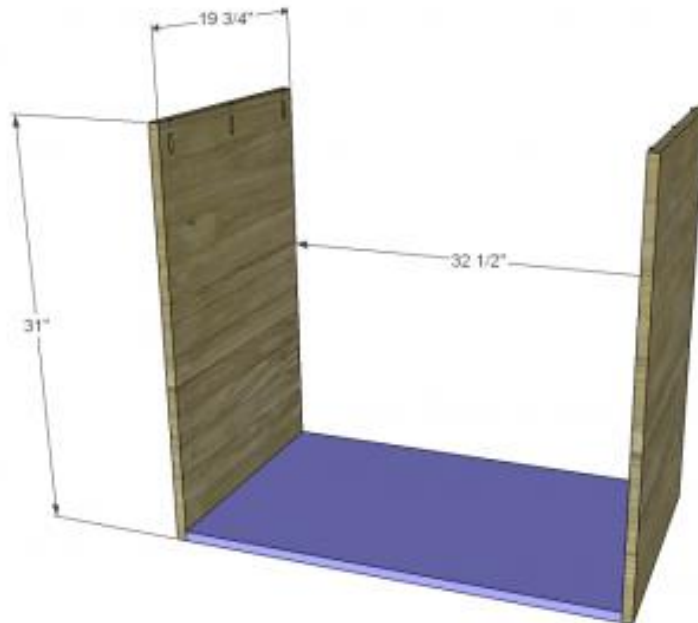

Edge banding should be applied to all exposed edges of plywood before assembly. Cut the pieces for the sides and bottom. Set the Kreg jig for $\frac{3}{4}$ " material and drill pocket holes in each end of the bottom piece as well as the top of the side pieces. Attach using glue and 1- $\frac{1}{2}$ " pocket hole screws.

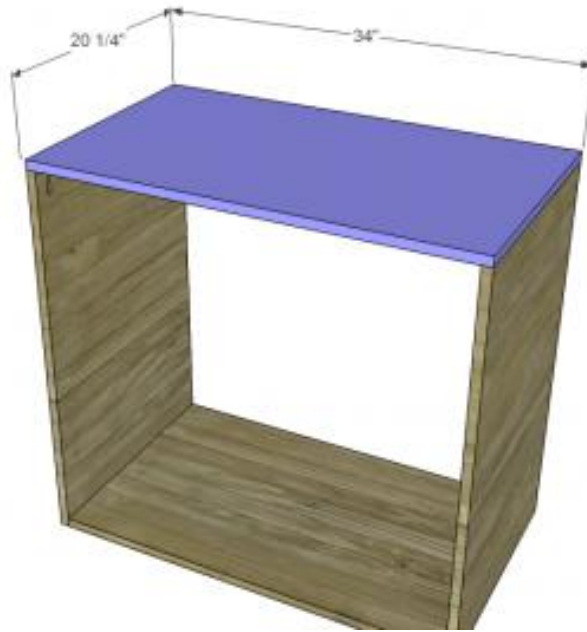

Cut the piece for the top. Attach to the sides using glue and 1-1/2" pocket hole screws through the holes in the sides into the top. Check for square.

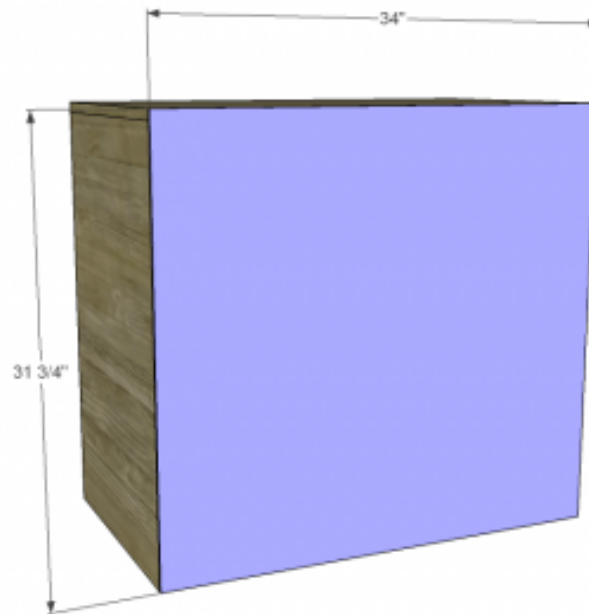

Cut the piece for the back then attach using glue and 1" brad nails.

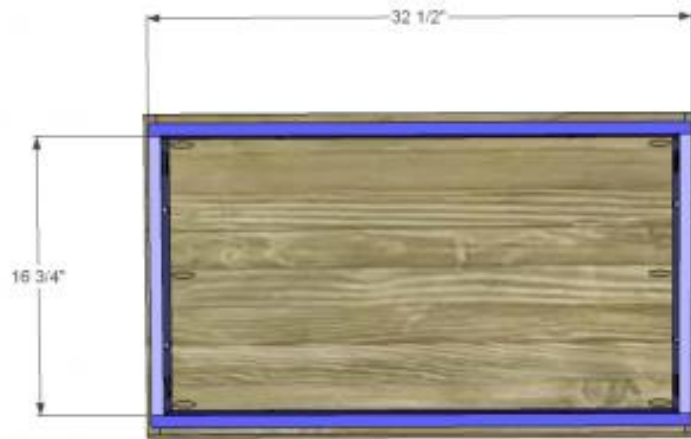

Cut the pieces for the pedestal. Drill pocket holes in each end of the shorter pieces, as well as one long end of each piece. Assemble the frame using glue and 1-1/2" pocket hole screws, then attach to the bottom of the cabinet. There will be a 3/4" border around the pedestal.

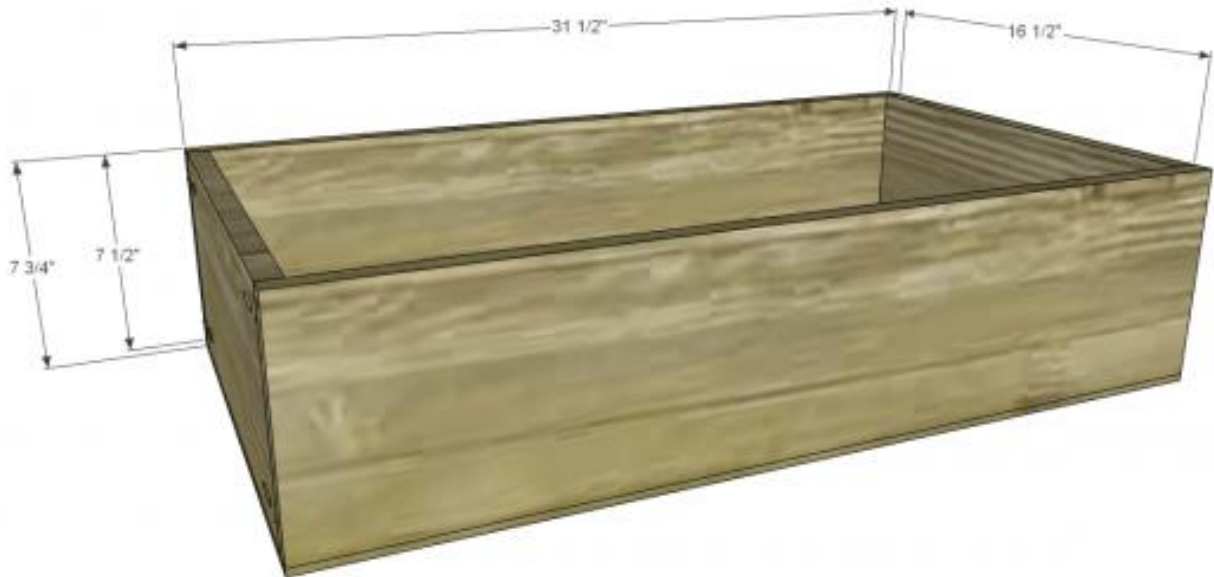

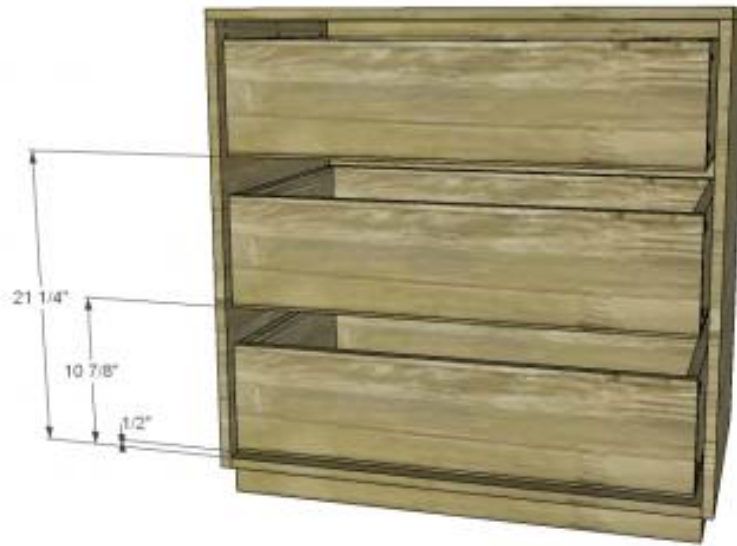

Cut the pieces for the drawer boxes. Assemble as shown using glue and 1-1/2" pocket hole screws. Cut the pieces for the drawer box bottoms and attach using glue and 1" brad nails. Attach the drawer slide hardware according to the manufacturer's instructions.

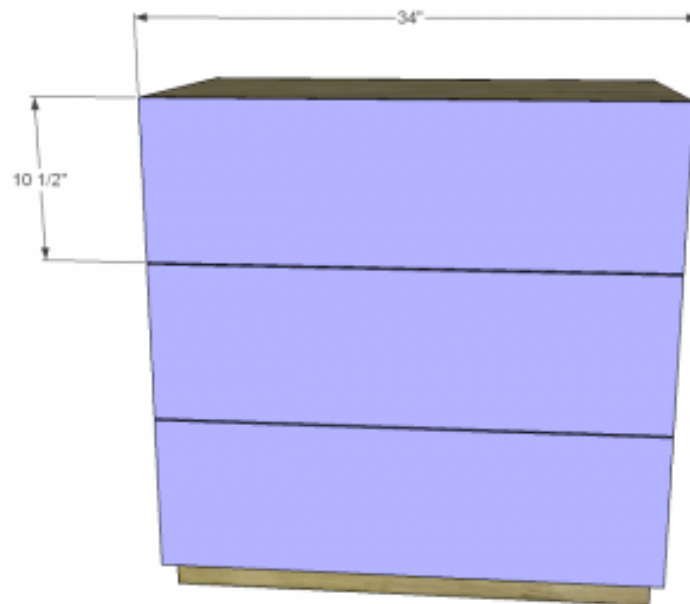

Cut the pieces for the drawer fronts. Attach to the drawer boxes with glue and a few 1" brad nails. Place the brad nails where they will be covered by the trim slats.

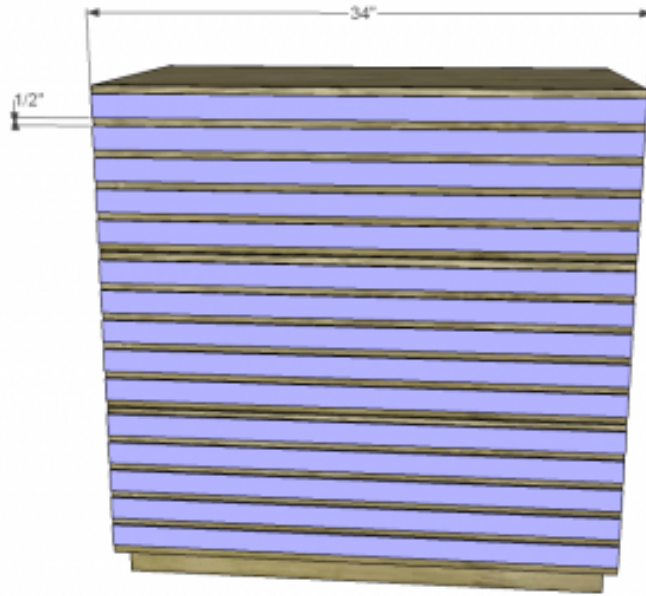

Cut the pieces for the trim slats. There will be $\frac{1}{2}$ " spacing between slats. Attach to the drawer fronts using glue and 1" brad nails.

Fill any Screw, Nail or Pocket Holes, Sand and Finish as Desired.