



ADD THESE DIY THREE-DRAWER DRESSER PLANS TO YOUR ORGANIZATIONAL TO-DO LIST!

The new year is sneaking up quickly and for me, it will mean making a better effort to get organized! These DIY three-drawer dresser plans will fit the bill and keep my stuff neatly put away! Featuring a narrow profile, tapered legs with a bevel detail on the outside edge, as well as an angle cut at the front edges of the top, this dresser will quickly become a classic piece of furniture!

BUILD THE COSMO DRESSER



MATERIALS:

- 1-1/4" pocket hole screws
- 1-1/4" brad nails
- Edge banding, optional
- 3 sets of drawer slides (shortened to 11-1/2")
- 3 cabinet pulls

LUMBER:

- 3 – 1×2 at 8'
- 4 – 1×8 at 6'
- 2 – 2×2 at 6'
- 1 – 2' x 4' sheet of 3/4" plywood
- 1 full sheet of 3/4" plywood

CUT LIST:

- 4 – 2×2 at 31-3/4" – Legs
- 4 – 1×2 at 11" – Side Frames
- 2 – 3/4" plywood at 11" x 26-1/4" – Side Panels
- 6 – 1×2 at 36" – Back Frame & Front Stretchers
- 1 – 3/4" plywood at 26-1/4" x 36" – Back
- 1 – 3/4" plywood at 14-1/2" x 40" – Top
- 3 – 3/4" plywood at 10" x 33-1/2" – Drawer Bottoms
- 6 – 1×8 at 10" – Drawer Box Sides
- 6 – 1×8 at 35" – Drawer Box Front & Back
- 3 – 3/4" plywood at 8" x 35-3/4" – Drawer Fronts



Notes:

Edge banding will be applied to the exposed edges of the plywood before assembly.

STEP ONE

Cut the pieces for the legs. Cut a 45 degree bevel in one edge of each piece at 27-3/4" long. Cut the taper in the lower edge of each piece using a jigsaw or a tapering jig on the table saw. The tapers will face to the inside of the dresser while the beveled edges will face to the outside edge. Keep in mind there will be two legs with the bevel on the right and two legs with the bevel on the left.

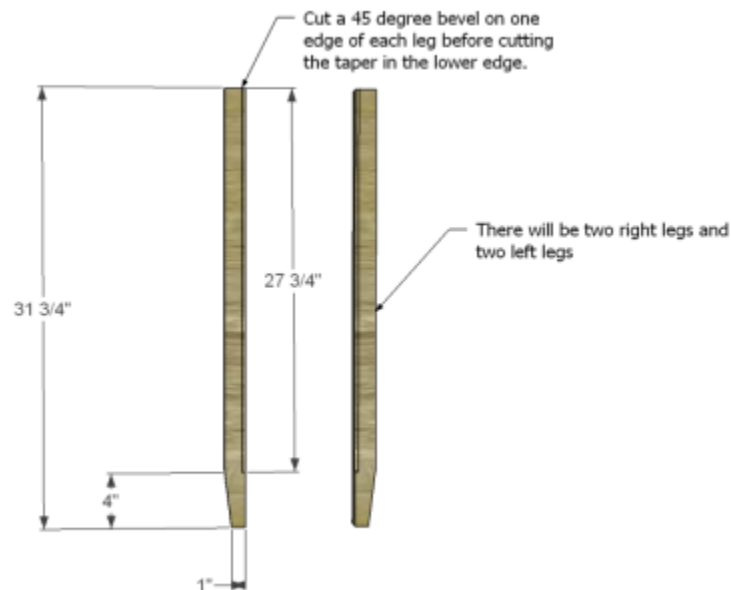

STEP TWO

Cut the pieces for the side frame and panels. With the pocket hole jig set for 3/4" material, drill pocket holes in each end of the frame pieces as well as all four edges of the panels. Secure the frame pieces to the panels using glue and 1-1/4" pocket hole screws. The back face of the panel will be flush with the back edge of the frame pieces. Orient the pocket holes in the frame pieces so they face away from the panels. Secure the panel assembly to the legs using glue and 1-1/4" pocket hole screws.

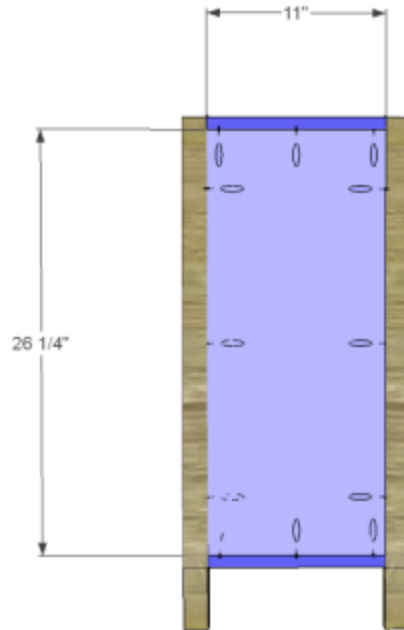

STEP THREE

Cut the pieces for the back frame, front stretchers, and back panel. Drill pocket holes in each end of the frame pieces and stretchers, as well as all four edges of the panel. Secure the frame pieces to the panel using glue and 1-1/4" pocket hole screws. The back face of the panel will be flush with the back edge of the frame pieces. Orient the pocket holes in the frame pieces so

they face away from the panels.

Secure the panel assembly to the legs using glue and 1-1/4" pocket hole screws.

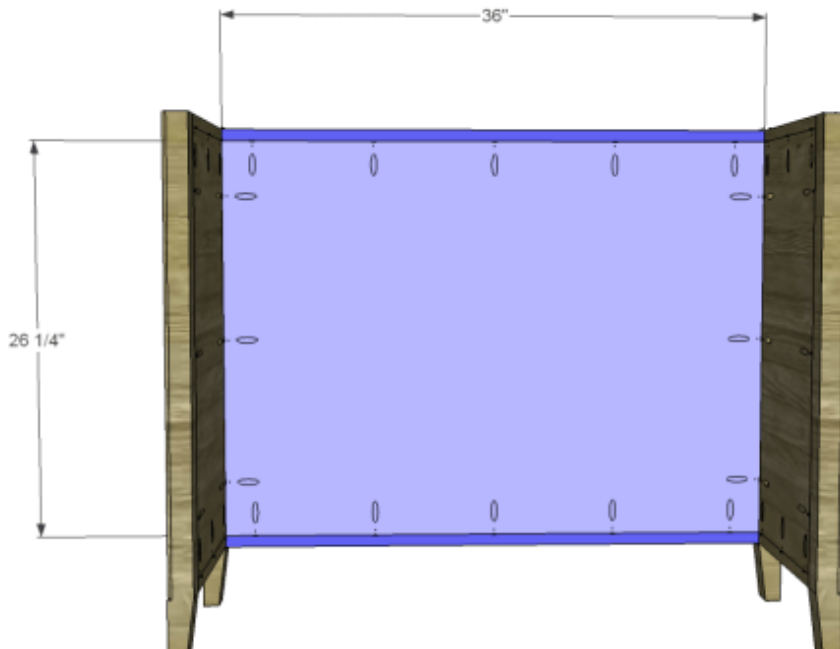

Secure the stretchers to the front legs as shown using glue and 1-1/4" pocket hole screws.

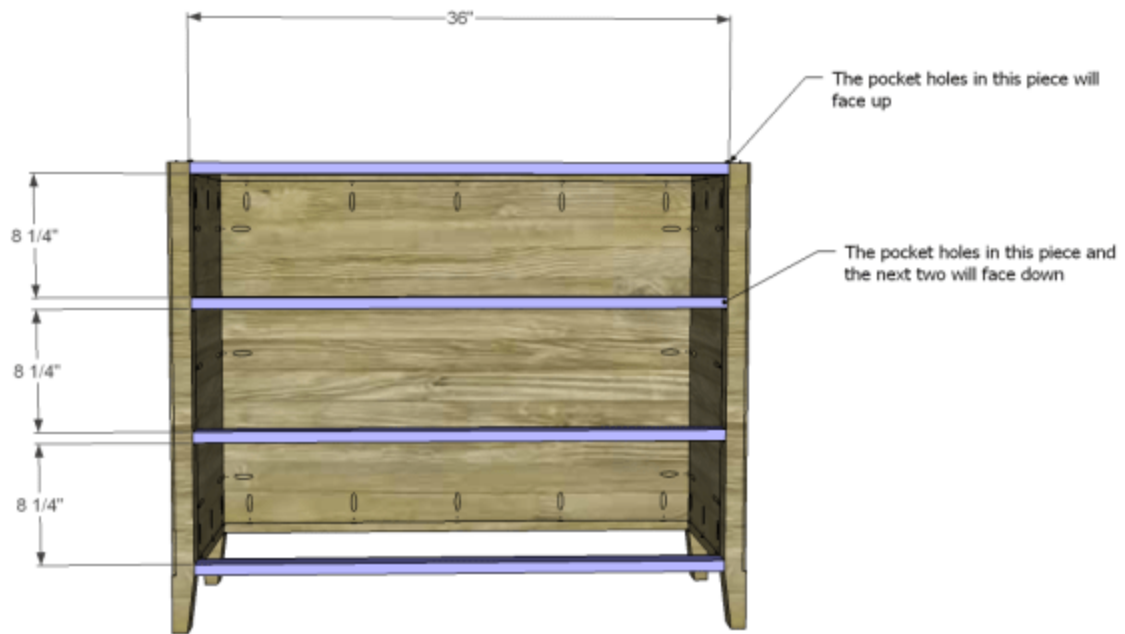

STEP FOUR

Cut the piece for the top. Cut a 45 degree bevel in each corner of the front edge making it 1/4" deep. The front and sides will overhang by 1/2". Secure using glue and 1-1/4" brad nails.

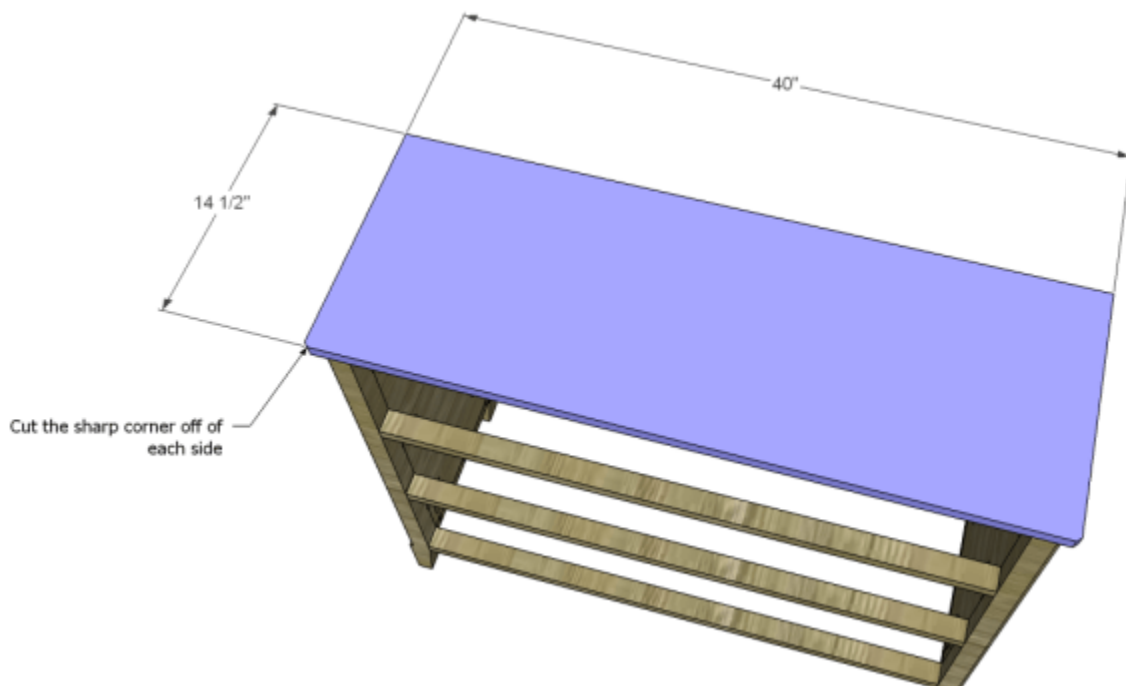

STEP FIVE

Cut the pieces for the drawer boxes. Drill pocket holes in all four edges of the bottom as well as each end of the sides. Assemble the drawer box as shown using glue and 1-1/4" pocket hole screws.

Use a hacksaw to shorten the drawer slides. Install the drawer slides according to the manufacturer's installation instructions, locating them $\frac{3}{4}$ " back from the front edge of the sides. Make any necessary adjustments.

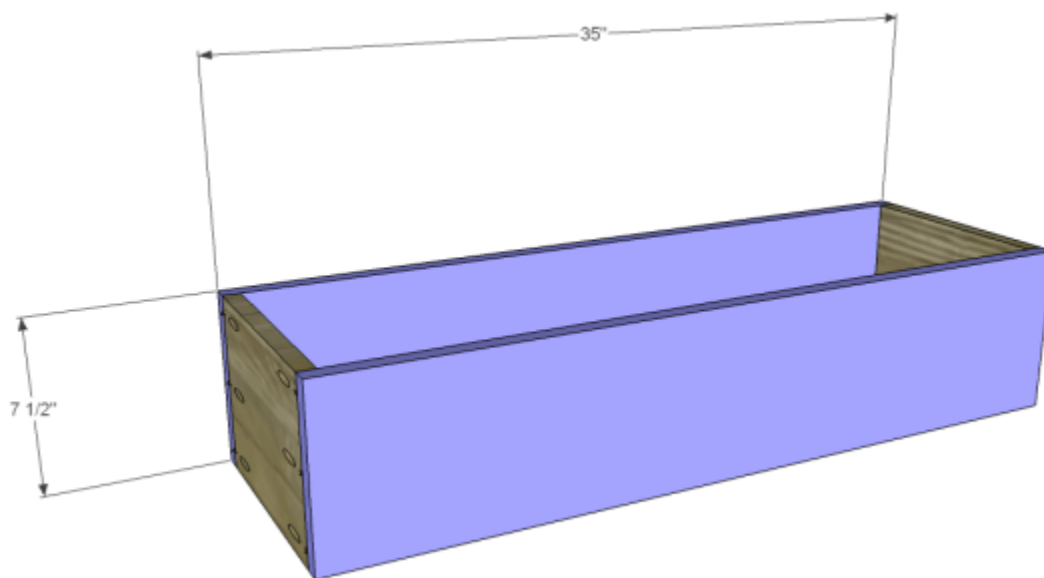
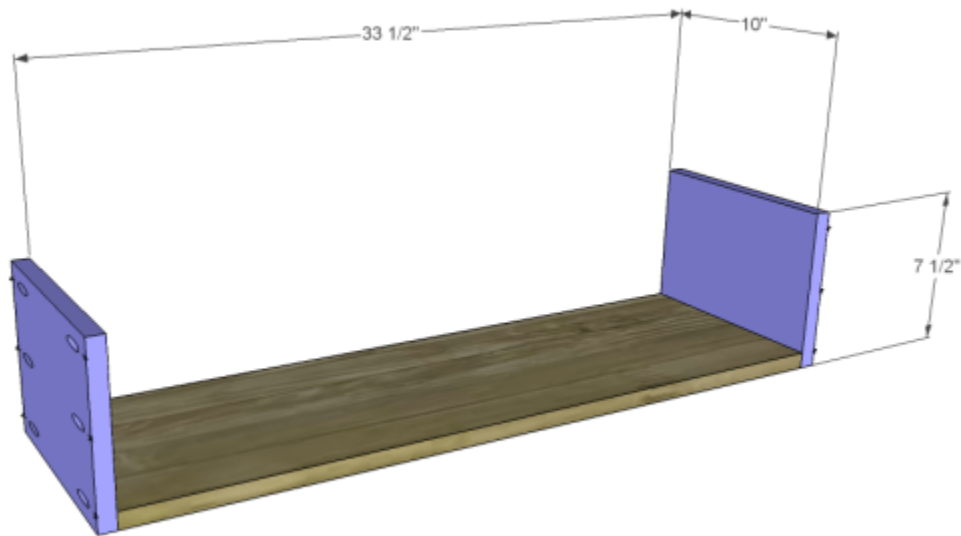

STEP SIX

Cut the pieces for the drawer fronts. Mark the position for the drawer pulls and drill the holes. Shim the drawer front in the opening – there will be a 1/8" gap around all sides – then drive screws through the holes for the drawer pulls into the drawer box. Open the drawer, and secure the drawer front using countersunk 1-1/4" screws from the inside. Remove the screws from the holes for the drawer pull then finish drilling the holes. Install the drawer pull.

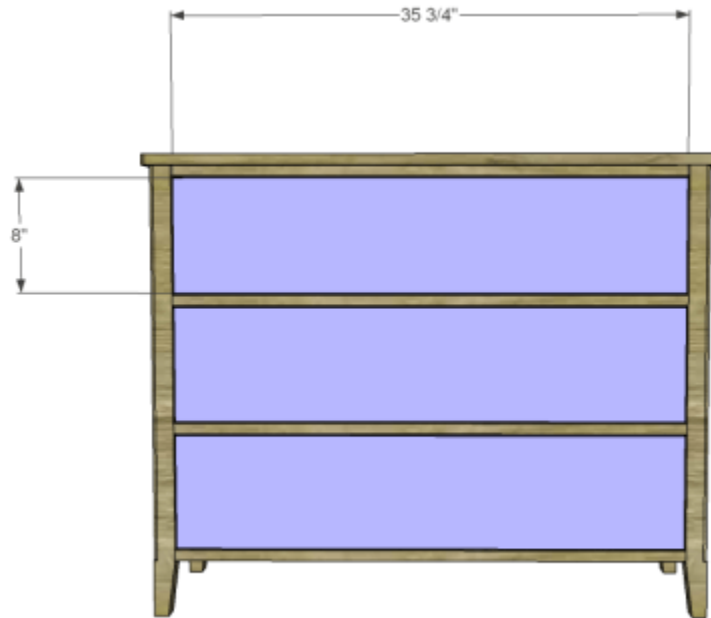

Finish as desired!