

3 Drawer Dresser

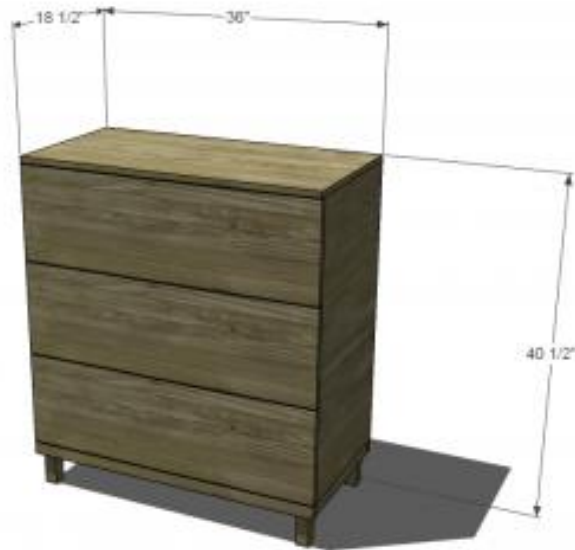

Materials:

- 3 – 1×2 at 6'
- 3 – 1×10 at 6'
- 2 – 1×10 at 8'
- 1 – 2×2 at 4'
- 2 sheets of 3/4" plywood
- 1-1/4" pocket hole screws
- 2-1/2" screws
- 1-1/4" brad nails
- 3 sets of 16" drawer slides

Cut List:

- 1 – $\frac{3}{4}$ " plywood at 17" x 34- $\frac{1}{2}$ " – Bottom
- 2 – 1x2 at 17" – Bottom Frame
- 2 – 1x2 at 36" – Bottom Frame
- 4 – 2x2 at 4- $\frac{3}{4}$ " – Legs
- 2 – $\frac{3}{4}$ " plywood at 17- $\frac{3}{4}$ " x 34- $\frac{1}{4}$ " – Sides
- 1 – $\frac{3}{4}$ " plywood at 34- $\frac{1}{4}$ " x 34- $\frac{1}{2}$ " – Back
- 2 – 1x2 at 34- $\frac{1}{2}$ " – Stretchers
- 1 – $\frac{3}{4}$ " plywood at 18- $\frac{1}{2}$ " x 36" – Top
- 3 – $\frac{3}{4}$ " plywood at 14- $\frac{1}{2}$ " x 32" – Drawer Bottoms
- 6 – 1x10 at 14- $\frac{1}{2}$ " – Drawer Box Sides
- 6 – 1x10 at 33- $\frac{1}{2}$ " – Drawer Box Front & Back
- 3 – $\frac{3}{4}$ " plywood at 11- $\frac{1}{4}$ " x 36" – Drawer Fronts

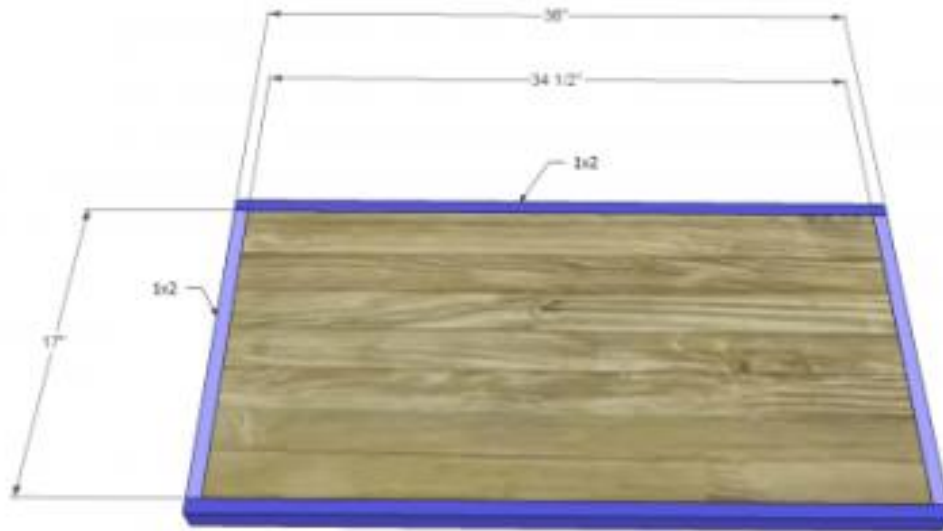

Cut the pieces for the bottom panel and the bottom frame. Set the Kreg jig for $\frac{3}{4}$ " material and drill pocket hole in each end of the shorter 1x2 frame pieces as well as all four edges of the bottom panel. Assemble the panel as shown using glue and 1- $\frac{1}{4}$ " pocket hole screws. Insert the panel then secure using glue and 1- $\frac{1}{4}$ " pocket hole screws. The top face of the panel will be flush with the top edge of the frame.



Cut the pieces for the legs. Position them on the underside of the bottom snug against the frame in each corner. Secure using glue and countersunk 2-1/2" screws through the bottom into the legs.

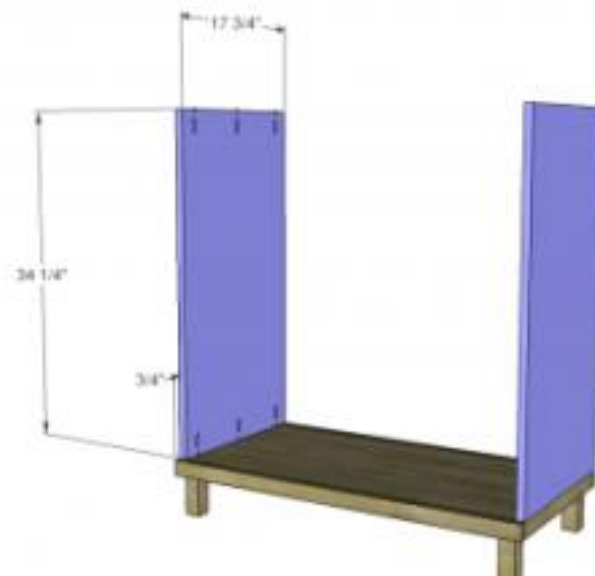

Cut the pieces for the sides and drill pocket holes in the top and bottom edges. Secure to the bottom frame locating them 3/4" back from the front edge of the bottom frame.

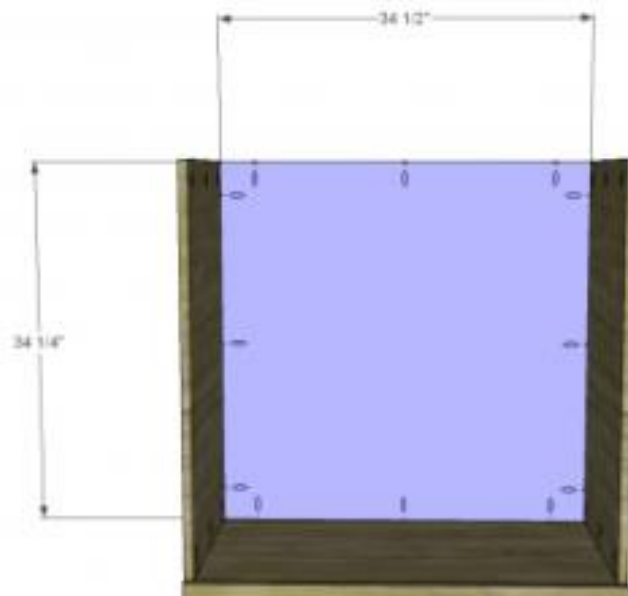

Cut the piece for the back and drill pocket holes in all four edges of the panel. Secure to the sides and bottom using glue and 1-1/4" pocket hole screws.

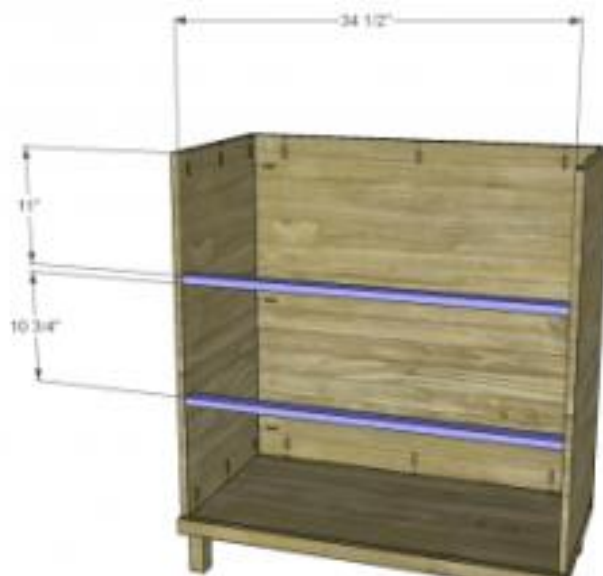

Cut the pieces for the stretchers and drill pocket holes in each end. Secure to the sides as shown using glue and 1-1/4" pocket hole screws.

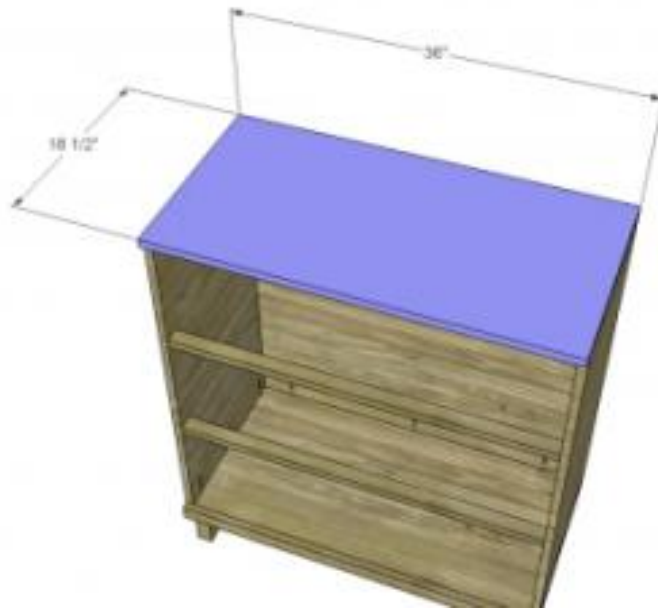

Cut the piece for the top. The front and sides will overhang by 1/2". Secure using glue and 1-1/4" pocket hole screws through the sides and back.

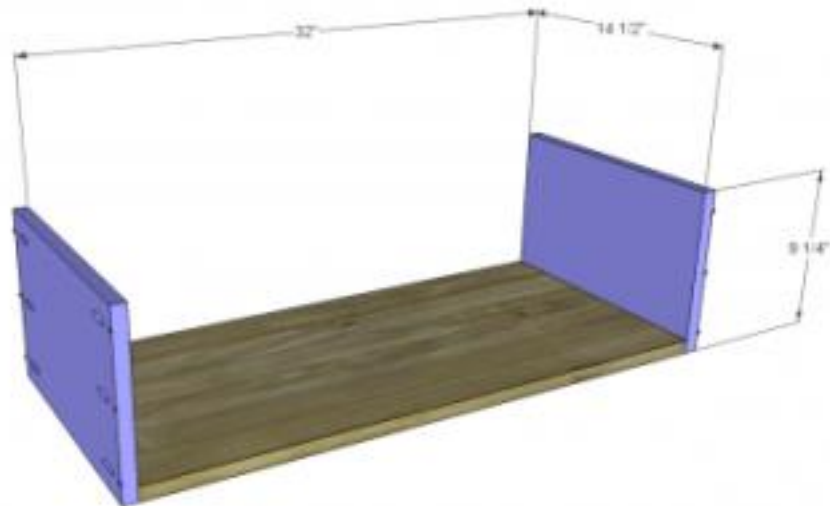

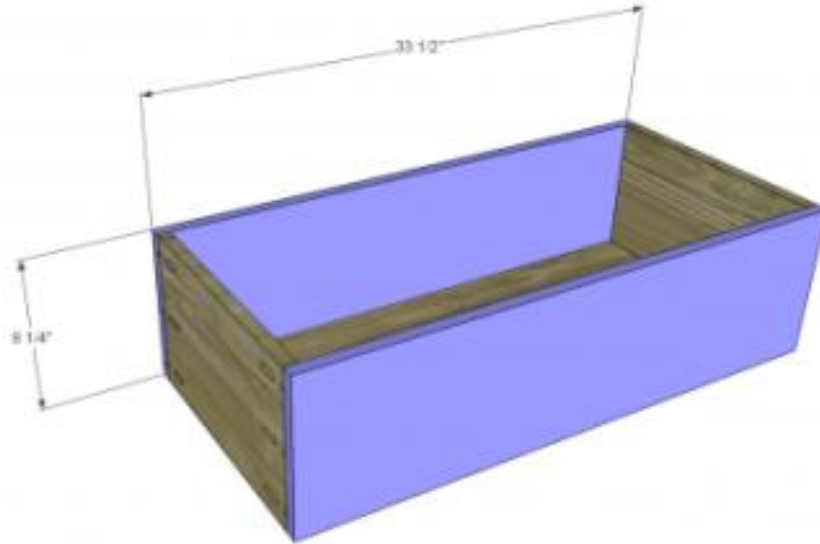

Cut the pieces for the drawer boxes. Drill pocket holes in all four edges of the bottom as well as each end of the sides. Assemble the drawer box as shown using glue and 1-1/4" pocket hole screws. Install the drawer slides according to the manufacturer's installation instructions, locating them 3/4" back from the front edge of the sides. Make any necessary adjustments.

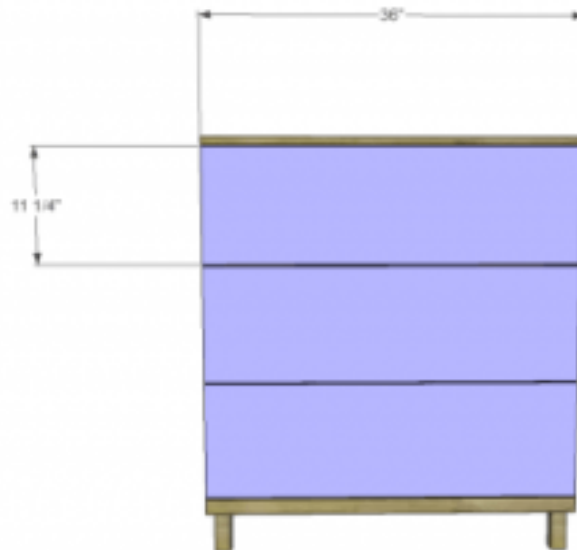

Cut the pieces for the drawer fronts. Mark the position for the drawer pulls and drill the holes. Starting with the bottom drawer front, position it with a 1/8" gap at the bottom then drive screws through the holes for the drawer pulls into the drawer box. Open the drawer, and secure the drawer front using countersunk 1-1/4" screws from the inside. Position the next drawer fronts in the same manner with a 1/8" gap between them and secure the same way. Remove the screws from the holes for the drawer pull then finish drilling the holes. Install the drawer pull.

Fill any Screw, Nail or Pocket Holes, Sand and Finish as Desired.