

Gabriela Dresser

This dresser, though it has tons of drawers, is a super-easy build. Featuring a total of twelve drawers, the DIY plans to build a Gabriela Dresser are perfect for a shared kids room, a craft room, or in a dining room. Each of the drawers in the vertical columns are a different size and will accommodate a variety of clothing or accessories. The entire dresser, drawers, and drawer fronts are constructed from 1/2" material.



build a gabriela dresser

MATERIALS:

- 1" pocket hole screws
- 1" brad nails
- Edge banding, optional
- 12 sets of 12" Drawer slides
- Cabinet pulls
- Wood glue
- Sandpaper (100, 150, 220 grits)
- Finishing supplies (primer & paint, or stain, sealer)

LUMBER:

- 13 – 1/2" thick by 1-1/2" wide boards at 3' (also called "craft boards") **OR**
- 9 – 1/2" thick by 1-1/2" wide boards at 4'

- 2 – 2×2 at 6'
- 1 – 4' x 4' sheet of 1/4" plywood
- 2 – 4' x 8' sheets of 1/2" plywood

CUT LIST:

- 4 – 2×2 at 32-1/4" – Legs
- 2 – 1/2" x 1-1/2" boards at 14" – Upper Side Framing
- 2 – 1/2" plywood at 14" x 27-1/4" – Side Panels
- 1 – 1/2" plywood at 16" x 46" – Bottom
- 2 – 1/2" plywood at 16" x 27-3/4" – Dividers
- 24 – 1/2" x 1-1/2" boards at 14" – Front & Back Stretchers
- 1 – 1/4" plywood at 28-1/4" x 44" – Back
- 1 – 1/2" plywood at 16-3/4" x 47" – Top
- 12 – 1/2" plywood at 11" x 12" – Drawer Box Bottoms
- 6 – 1/2" plywood at 3-1/2" x 11" – Drawer Box #1 Sides
- 6 – 1/2" plywood at 3-1/2" x 13" – Drawer Box #1 Front & Back
- 6 – 1/2" plywood at 4-1/2" x 11" – Drawer Box #2 Sides
- 6 – 1/2" plywood at 4-1/2" x 13" – Drawer Box #2 Front & Back
- 6 – 1/2" plywood at 5-1/2" x 11" – Drawer Box #3 Sides
- 6 – 1/2" plywood at 5-1/2" x 13" – Drawer Box #3 Front & Back
- 6 – 1/2" plywood at 6-1/2" x 11" – Drawer Box #4 Sides
- 6 – 1/2" plywood at 6-1/2" x 13" – Drawer Box #4 Front & Back
- 3 – 1/2" plywood at 4-1/2" x 13-3/4" – Drawer Fronts #1
- 3 – 1/2" plywood at 5-3/4" x 13-3/4" – Drawer Fronts #2
- 3 – 1/2" plywood at 6-3/4" x 13-3/4" – Drawer Fronts #3
- 3 – 1/2" plywood at 7-3/4" x 13-3/4" – Drawer Fronts #4



STEP ONE:

Cut the pieces for the legs. Cut the taper in the lower end using a jigsaw or a tapering jig on a table saw.



STEP TWO

Cut the pieces for the upper side framing and the side panels. With the pocket hole jig set for 1/2" material, drill pocket holes in each end of the framing pieces. Secure the framing pieces to the legs using glue and 1" pocket hole screws. The tapers on the legs will face to the inside.

Cut the pieces for the side panels and drill pocket holes in all four edges. Secure the panels to the legs and the framing piece using glue and 1" pocket hole screws. The back face of the panels will be flush with the inside face of the legs.

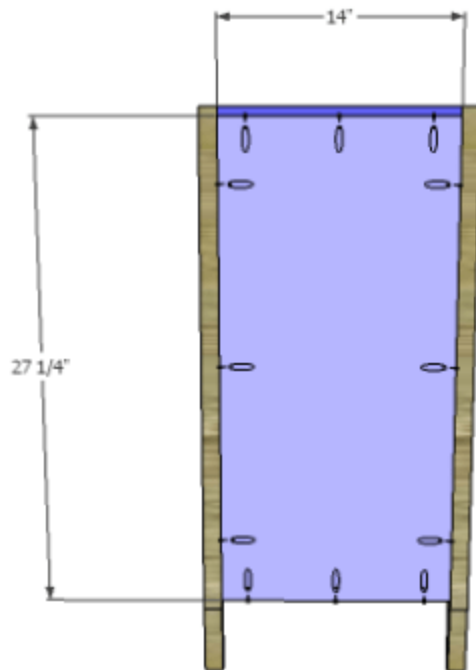

STEP THREE

Cut the piece for the bottom. Cut the notches using a jigsaw. Secure the bottom between the lower end of the side legs using glue and 1" pocket hole screws through the side panels into the bottom.

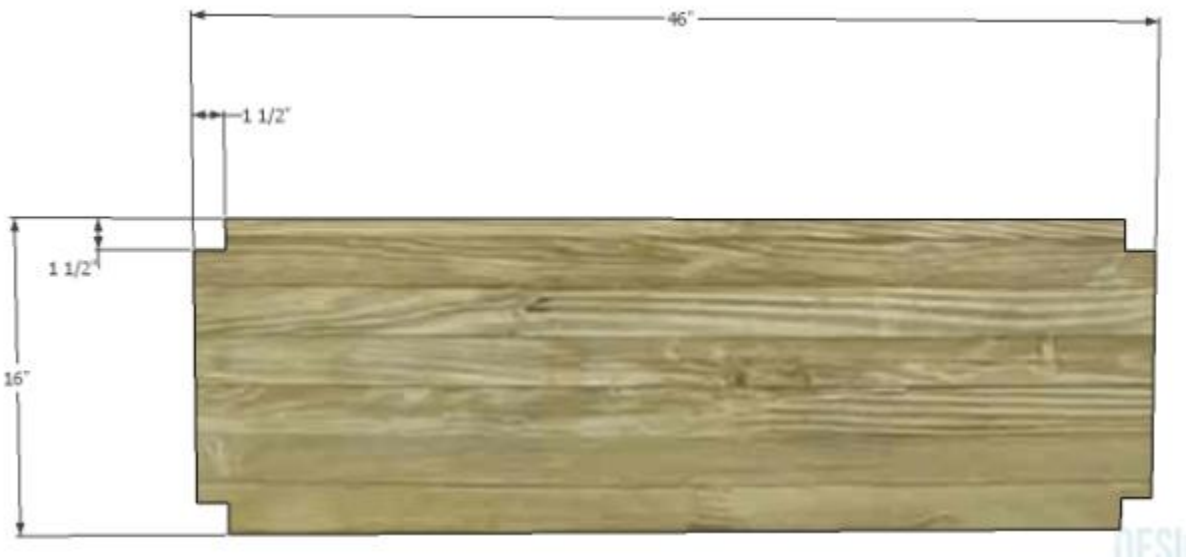

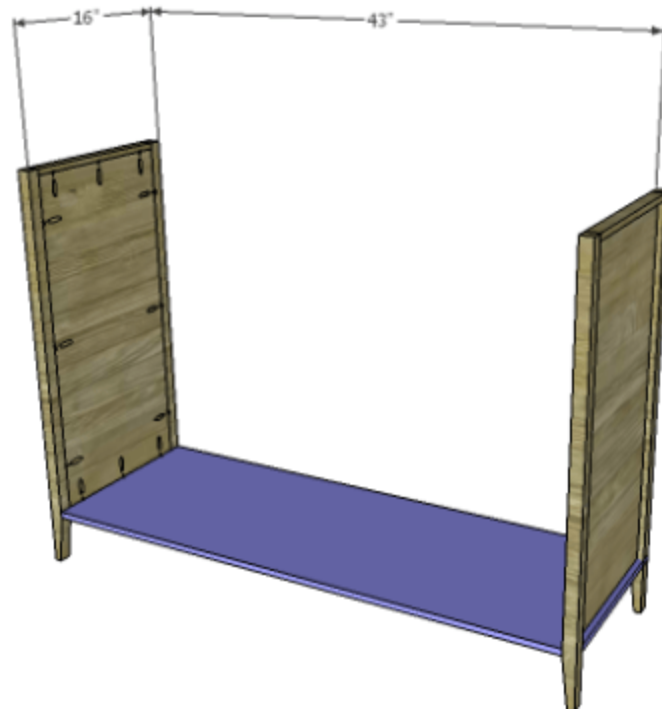

STEP FOUR

Cut the pieces for the dividers and drill pocket holes in the lower end of each piece. Secure the dividers to the bottom using glue and 1" pocket hole screws.

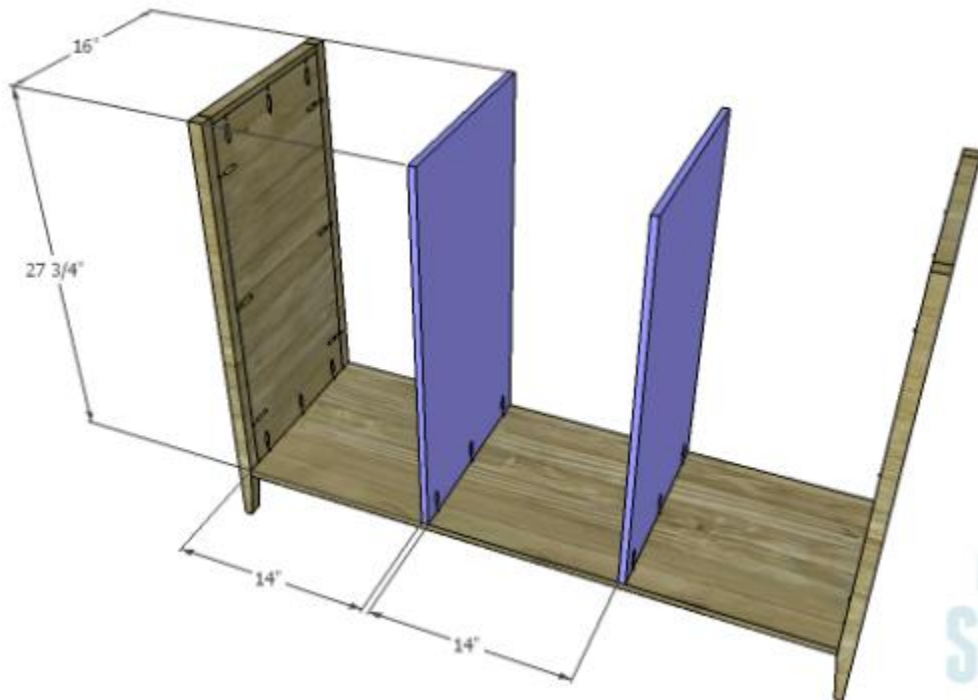

STEP FIVE

Cut the pieces for the front and back stretchers, and drill pocket holes in each end of a total of 16 pieces. The remaining eight will be secured with brad nails. Starting with the center back stretchers, secure them dividers as shown using glue and 1" brad nails. Secure the remaining stretchers using glue and 1" pocket hole screws to the legs and dividers.

Repeat the process for the front stretchers.



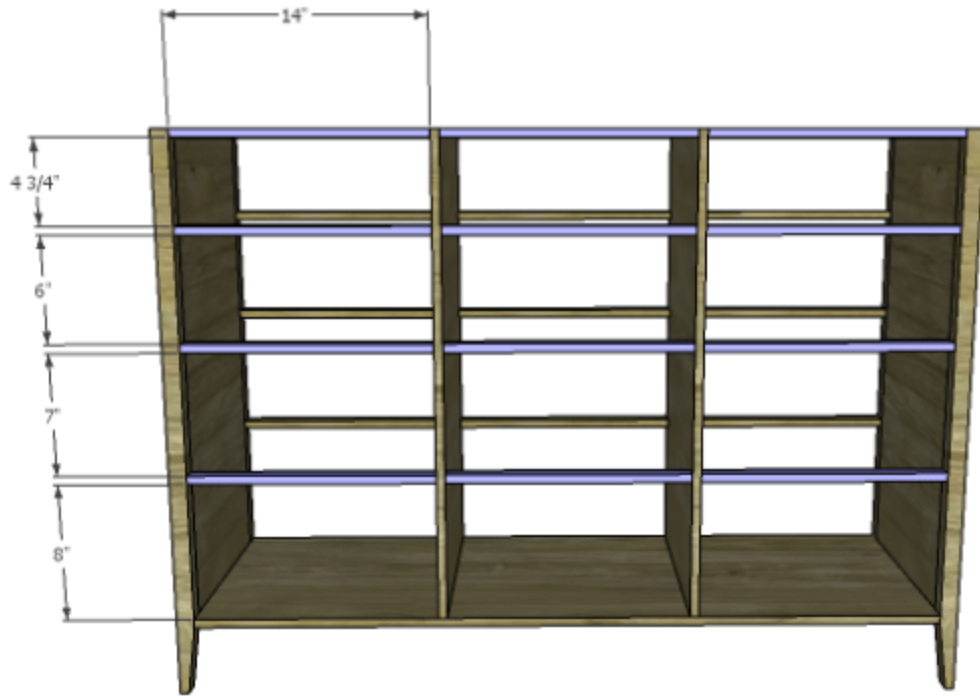

STEP SIX

Cut the piece for the back. Secure the back using glue and 1" brad nails through the back into the legs and stretchers.

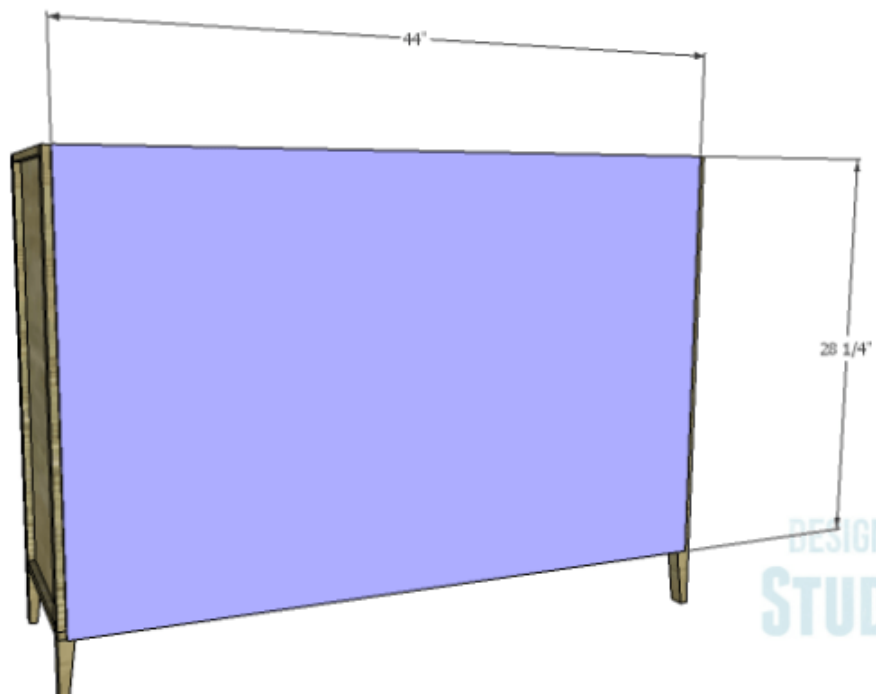

STEP SEVEN

Cut the piece for the top. The front and sides will overhang by 1/2", and the back edge will cover the top of the back piece. Secure in place using glue and 1" brad nails.

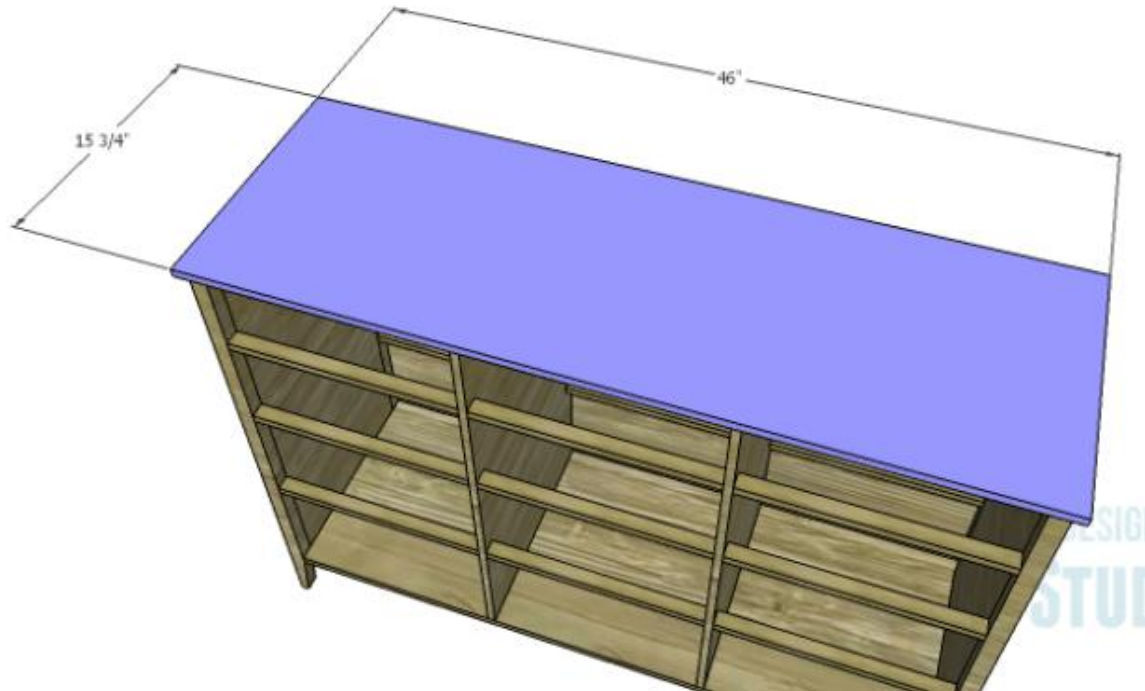

STEP EIGHT

Cut the pieces for the drawer boxes. The drawer box bottoms are all the same size. The sides, front and back of the drawer boxes are all the same length but are different heights. All of the drawers are assembled in the same manner and are shown in the drawing. In the cut list, the drawers are listed in order from top to bottom.

Drill pocket holes in all four edges of the bottom as well as each end of the sides. Assemble the drawer boxes as shown using glue and 1" pocket hole screws. Install the drawer slides according to the manufacturer's installation instructions, locating them 3/4" back from the front edge of the sides. For an easy tutorial, [click here](#). Make any necessary adjustments.

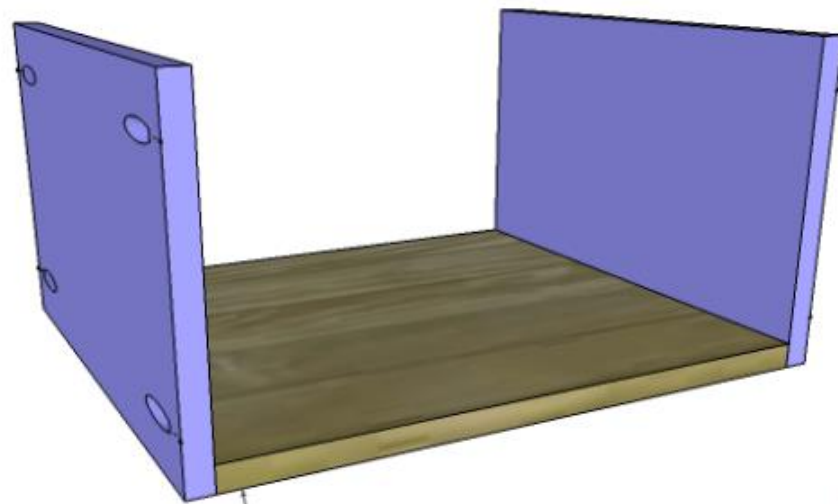

Secure the bottom to the sides using glue and 1" pocket hole screws

DI
ST

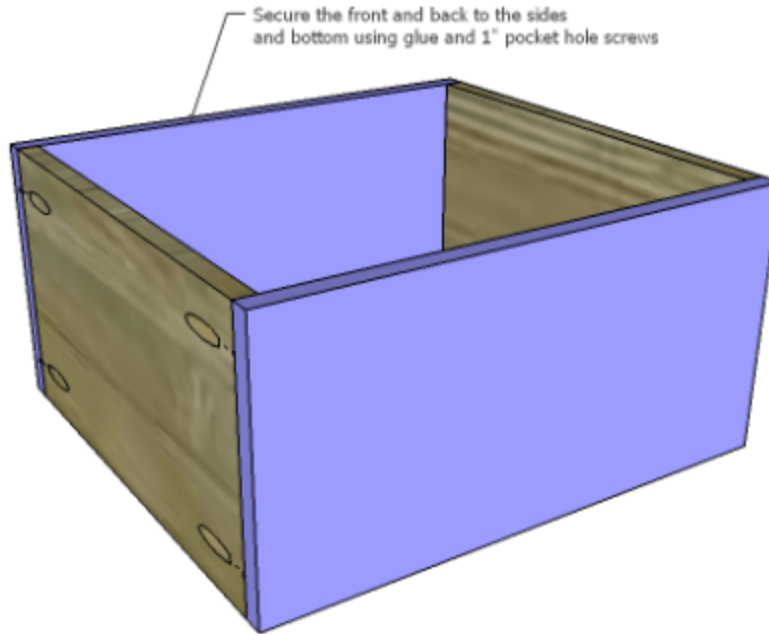

Secure the front and back to the sides and bottom using glue and 1" pocket hole screws

STEP NINE

Cut the pieces for the drawer fronts. Mark the position for the drawer pulls and drill the holes. Shim the drawer front in the opening – there will be a 1/8" gap around all sides – then drive screws through the holes for the drawer pulls into the drawer box. Open the drawer, and secure the drawer front using countersunk 1-1/4" screws from the inside. Remove the screws from the holes

for the drawer pull then finish drilling the holes. Install the drawer pull. For an easy tutorial on installing drawer fronts, [click here](#).

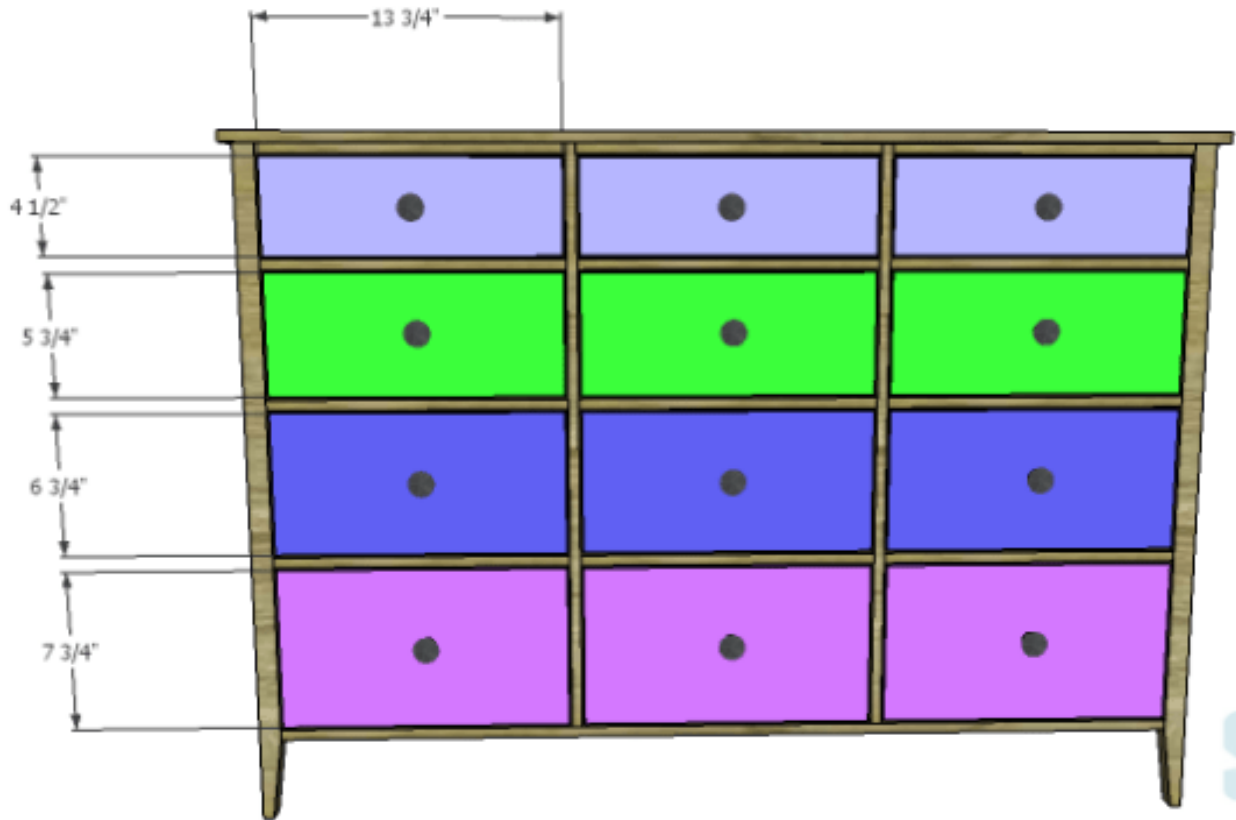

Finish the dresser as desired.