

Shim Headboard

There's no cutting needed to make these textured and colorful headboard panels. Just assemble with glue and paint them to match your bedroom decor.



Materials

- ¼ x 24 x 48 birch plywood panels
- 11 – wood shim packs of 12
- Large D-ring hangers, pack of 4
- Valspar spray paint

Items may be Special Order in some stores. Product costs, availability, and item numbers may vary online or by market. Paint colors may vary slightly from those shown. Availability varies by market for lumber species and sizes.

Instructions

You can hang these panels vertically or horizontally, depending on the look you want and the size of your mattress. For example, three panels hung vertically and spaced about 14 inches apart will span the width of a king-size mattress, while a single panel hung horizontally will span a twin mattress. For

a queen-size mattress, space three panels 6 inches apart. For a double or full-size mattress, space the three panels 3 inches apart.

Step 1

Cut a 24 x 48 panel into three 16 x 24 pieces. If you don't have a circular saw or table saw, have a Lowe's associate cut the plywood for you.

Step 2



On a 16 x 24 panel, begin by gluing a shim in each corner in a pinwheel pattern. The edges and ends of the shims should be flush with the edges of the panel. Allow these pieces to dry for an hour before you continue.

Step 3

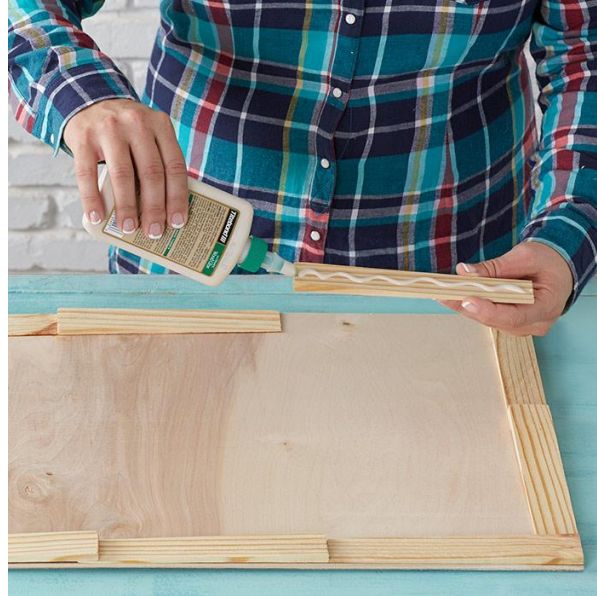

Fill in the remaining boundary shims, keeping the overlaps as identical as possible from side to side and top to bottom.

Step 4

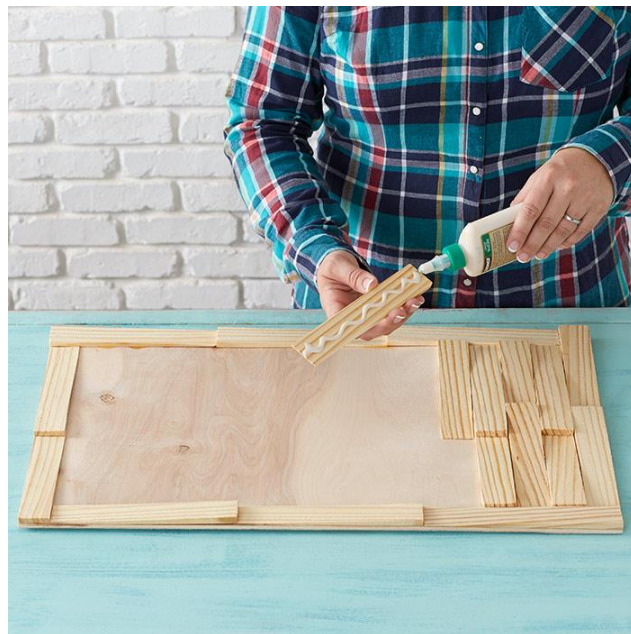

Begin filling in the rest of the panel by adding two shims running the opposite direction of two end shims. Add weights while each row dries for about 20 minutes. Then continue adding shims, alternating their direction by row, and applying weight to each row until you reach the top. Repeat for the remaining panels and allow the glue to dry overnight before painting.

Step 5

Spray two coats of paint on the front and sides, varying the spray angles to reach into the recessed areas of the shims. Then paint the back.

Good to Know

Painting the back isn't necessary for appearance, but it will help keep the panel from warping or twisting from moisture changes.

Step 6

If you hang the panels vertically, screw a D-ring hanger centered along the top edge on the back of the panel. For a horizontal panel, use two D-ring hangers. Repeat for the remaining panels.